

Refraction unit **ALPHA** master



ALPHA
master

CE

Refraction unit

Med
instrus

Refraction unit **ALPHA**_{master}

Refraction unit **ALPHA**_{master}

- Lifting table top for two instruments.
- Fixed height chair.
- Column with integrated two halogen lamps and plate for chart projector.
- Integrated cabinet with a drawer for trial lenses set and two additional drawers.
- Integrated transformer for instruments power supply.

Optional

- Phoroceptor arm.
- Chair sliding (13 cm) forward – backwards ass'y.
- Foot switch control for up / down movement of the chair.
- Left-handed version.

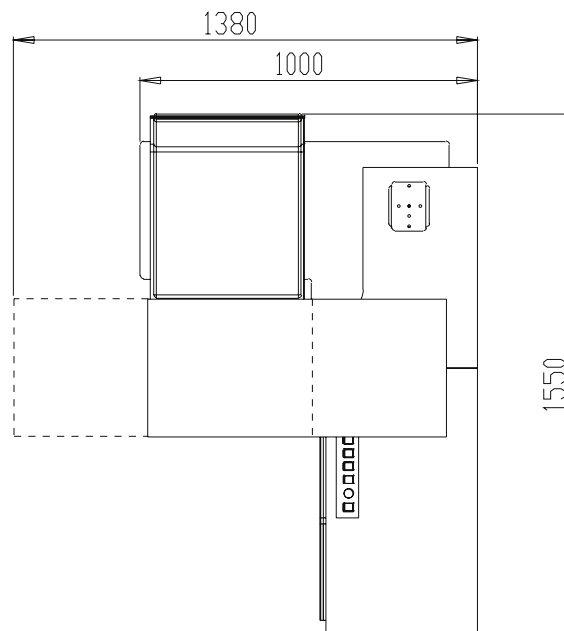

Technical information

Voltage	~230 V 50/60 Hz
Max height	140 kg
Max height	181 cm
Table height from the ground	from 70 cm to 95 cm (25 cm lift)
Chair height from the ground	45 cm
Overhead halogen lamp	2 x 12 V 35 W
Adjustable power supply for slit lamp/ophthalmometer	6 V and/or 12 V



UAB „Medinstrus“
Respublikos 20, LT - 89224 Mažeikiai,
Lietuva (Lithuania).

Tel: +370 443 25451
Fax: +370 443 25455
E-mail: info@medinstrus.lt
Web: www.medinstrus.lt